



SMAG Plastic-Encapsulate Diodes

1SMA47 SERIES Zener Diodes

Features

- Pd 1.0W.
- Vz 3.0V-300V.
- Range 5%.
- AEC Q101 Qualified.

Application

- Stabilizing Voltage.

Marking

- 1SMA47XXA
- XX : From 27 To 64 (Vz<100V)
- 1SZ1XXXXA
- XXX : From 110 To 300 (Vz>100V)

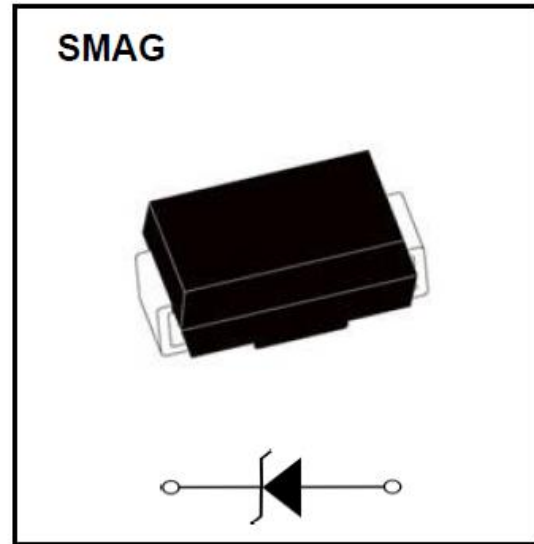

ABSOLUTE MAXIMUM RATINGS (T_a=25°C unless otherwise noted)

| Item | Symbol | Unit | Conditions | Max |
|------------------------------|------------------|------|-----------------------|--------------------------------|
| Power dissipation | P _d | W | T _L =75°C | 1.0 |
| Zener current | I _z | mA | | P _V /V _Z |
| Maximum junction temperature | T _j | °C | | -65 to +150 |
| Storage temperature range | T _{stg} | °C | | -65 to +150 |
| Forward voltage | V _F | V | I _F =200mA | 1.2 |

ELECTRICAL CHARACTERISTICS (T_a=25°C unless otherwise noted)

| Part Number | Nominal Zener Voltage | | Maximum Zener Impedance | | | Maximum Reverse Leakage Current | | Maximum DC Zener Current | Maximum Surge Current |
|-------------|----------------------------------|-----------------|-----------------------------------|-----------------------------------|-----------------|---------------------------------|-------|--------------------------|-----------------------|
| | V _Z @ I _{ZT} | I _{ZT} | Z _{ZT} @ I _{ZT} | Z _{ZK} @ I _{ZK} | I _{ZK} | I _R @ V _R | | I _{ZM} | I _{RM} |
| | (V) | (mA) | (Ω) | (Ω) | (mA) | (uA) | (V) | (mA) | (mApk) |
| 1SMA4727A | 3.0 | 83.0 | 10.0 | 400 | 1.00 | 150.0 | 1.0 | 274.0 | 1370 |
| 1SMA4728A | 3.3 | 76.0 | 10.0 | 400 | 1.00 | 100.0 | 1.0 | 274.0 | 1370 |
| 1SMA4729A | 3.6 | 69.0 | 10.0 | 400 | 1.00 | 100.0 | 1.0 | 251.0 | 1255 |
| 1SMA4730A | 3.9 | 64.0 | 9.0 | 400 | 1.00 | 50.0 | 1.0 | 232.0 | 1160 |
| 1SMA4731A | 4.3 | 58.0 | 9.0 | 400 | 1.00 | 20.0 | 1.0 | 210.0 | 1050 |
| 1SMA4732A | 4.7 | 53.0 | 8.0 | 500 | 1.00 | 10.0 | 1.0 | 192.0 | 960 |
| 1SMA4733A | 5.1 | 49.0 | 7.0 | 550 | 1.00 | 10.0 | 1.0 | 177.0 | 885 |
| 1SMA4734A | 5.6 | 45.0 | 5.0 | 600 | 1.00 | 10.0 | 2.0 | 161.0 | 805 |
| 1SMA4735A | 6.2 | 41.0 | 2.0 | 700 | 1.00 | 10.0 | 3.0 | 146.0 | 730 |
| 1SMA4736A | 6.8 | 37.0 | 3.5 | 700 | 1.00 | 5.0 | 4.0 | 133.0 | 660 |
| 1SMA4737A | 7.5 | 34.0 | 4.0 | 700 | 0.50 | 5.0 | 5.0 | 121.0 | 605 |
| 1SMA4738A | 8.2 | 31.0 | 4.5 | 700 | 0.50 | 5.0 | 6.0 | 110.0 | 550 |
| 1SMA4739A | 9.1 | 28.0 | 5.0 | 700 | 0.50 | 0.5 | 7.0 | 100.0 | 500 |
| 1SMA4740A | 10.0 | 25.0 | 7.0 | 700 | 0.25 | 0.5 | 7.6 | 91.0 | 454 |
| 1SMA4741A | 11.0 | 23.0 | 8.0 | 700 | 0.25 | 0.1 | 8.4 | 83.0 | 414 |
| 1SMA4742A | 12.0 | 21.0 | 9.0 | 700 | 0.25 | 0.1 | 9.1 | 76.0 | 380 |
| 1SMA4743A | 13.0 | 19.0 | 10.0 | 700 | 0.25 | 0.1 | 9.9 | 69.0 | 344 |
| 1SMA4744A | 15.0 | 17.0 | 14.0 | 700 | 0.25 | 0.1 | 11.4 | 61.0 | 305 |
| 1SMA4745A | 16.0 | 15.5 | 16.0 | 700 | 0.25 | 0.1 | 12.2 | 57.0 | 285 |
| 1SMA4746A | 18.0 | 14.0 | 20.0 | 750 | 0.25 | 0.1 | 13.7 | 50.0 | 250 |
| 1SMA4747A | 20.0 | 12.5 | 22.0 | 750 | 0.25 | 0.1 | 15.2 | 45.0 | 225 |
| 1SMA4748A | 22.0 | 11.5 | 23.0 | 750 | 0.25 | 0.1 | 16.7 | 41.0 | 205 |
| 1SMA4749A | 24.0 | 10.5 | 25.0 | 750 | 0.25 | 0.1 | 18.2 | 38.0 | 190 |
| 1SMA4750A | 27.0 | 9.5 | 35.0 | 750 | 0.25 | 0.1 | 20.6 | 34.0 | 170 |
| 1SMA4751A | 30.0 | 8.5 | 40.0 | 1000 | 0.25 | 0.1 | 22.8 | 30.0 | 150 |
| 1SMA4752A | 33.0 | 7.5 | 45.0 | 1000 | 0.25 | 0.1 | 25.1 | 27.0 | 135 |
| 1SMA4753A | 36.0 | 7.0 | 50.0 | 1000 | 0.25 | 0.1 | 27.4 | 25.0 | 125 |
| 1SMA4754A | 39.0 | 6.5 | 60.0 | 1000 | 0.25 | 0.1 | 29.7 | 23.0 | 115 |
| 1SMA4755A | 43.0 | 6.0 | 70.0 | 1500 | 0.25 | 0.1 | 32.7 | 22.0 | 110 |
| 1SMA4756A | 47.0 | 5.5 | 80.0 | 1500 | 0.25 | 0.1 | 35.8 | 19.0 | 95 |
| 1SMA4757A | 51.0 | 5.0 | 95.0 | 1500 | 0.25 | 0.1 | 38.8 | 18.0 | 90 |
| 1SMA4758A | 56.0 | 4.5 | 110.0 | 2000 | 0.25 | 0.1 | 42.6 | 16.0 | 80 |
| 1SMA4759A | 62.0 | 4.0 | 125.0 | 2000 | 0.25 | 0.1 | 47.1 | 14.0 | 70 |
| 1SMA4760A | 68.0 | 3.7 | 150.0 | 2000 | 0.25 | 0.1 | 51.7 | 13.0 | 65 |
| 1SMA4761A | 75.0 | 3.3 | 175.0 | 2000 | 0.25 | 0.1 | 56.0 | 12.0 | 60 |
| 1SMA4762A | 82.0 | 3.0 | 200.0 | 3000 | 0.25 | 0.1 | 62.2 | 11.0 | 55 |
| 1SMA4763A | 91.0 | 2.8 | 250.0 | 3000 | 0.25 | 0.1 | 69.2 | 10.0 | 50 |
| 1SMA4764A | 100.0 | 2.5 | 350.0 | 3000 | 0.25 | 0.1 | 76.0 | 9.0 | 45 |
| 1SZ1110A | 110.0 | 2.3 | 450.0 | 4000 | 0.25 | 0.1 | 83.6 | 8.6 | 40 |
| 1SZ1120A | 120.0 | 2.0 | 550.0 | 4500 | 0.25 | 0.1 | 91.2 | 7.8 | 37 |
| 1SZ1130A | 130.0 | 1.9 | 700.0 | 5000 | 0.25 | 0.1 | 98.8 | 7.0 | 34 |
| 1SZ1150A | 150.0 | 1.7 | 1000.0 | 6000 | 0.25 | 0.1 | 114.0 | 6.4 | 30 |
| 1SZ1160A | 160.0 | 1.6 | 1100.0 | 6500 | 0.25 | 0.1 | 121.6 | 5.8 | 28 |
| 1SZ1180A | 180.0 | 1.4 | 1200.0 | 7000 | 0.25 | 0.1 | 136.8 | 5.2 | 25 |
| 1SZ1200A | 200.0 | 1.2 | 1900.0 | 9990 | 0.25 | 0.1 | 152.0 | 4.7 | 22 |
| 1SZ1220A | 220.0 | 1.0 | 1600.0 | 8000 | 0.25 | 0.1 | 167.2 | 4.0 | 20 |
| 1SZ1240A | 240.0 | 0.9 | 1800.0 | 8500 | 0.25 | 0.1 | 182.4 | 3.8 | 19 |
| 1SZ1250A | 250.0 | 0.9 | 2000.0 | 9000 | 0.25 | 0.1 | 190.0 | 3.6 | 18 |
| 1SZ1270A | 270.0 | 0.8 | 2100.0 | 9000 | 0.25 | 0.1 | 205.0 | 3.3 | 16 |
| 1SZ1300A | 300.0 | 0.8 | 2300.0 | 9500 | 0.25 | 0.1 | 228.0 | 3.0 | 15 |

Typical Characteristics

FIG1: Maximum Continuous Power Dissipation

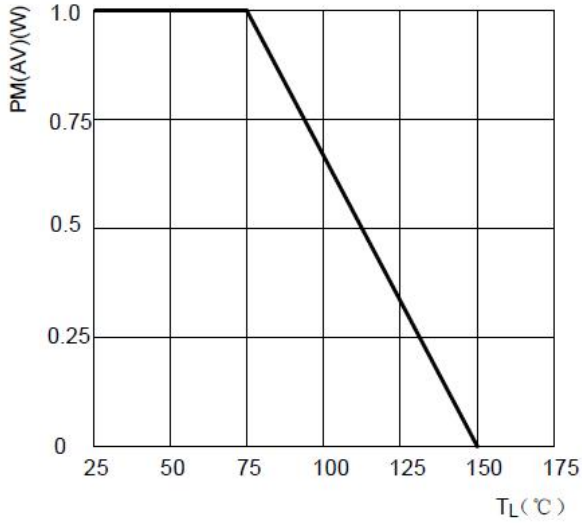

FIG2: Typical Zener Impedance

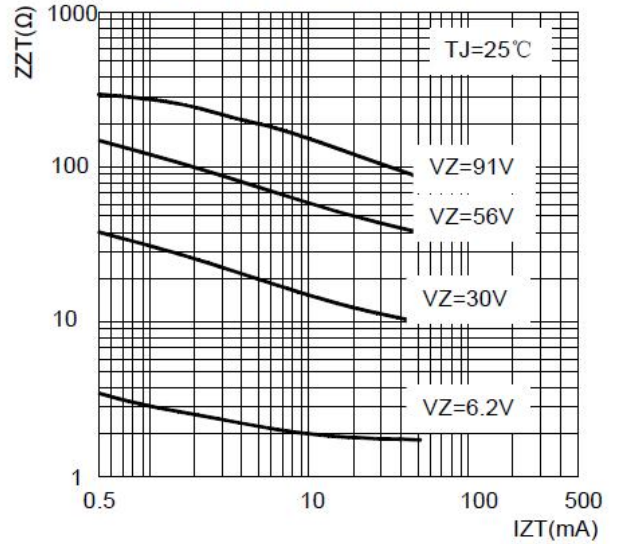

FIG3: Typical Temperature Coefficients

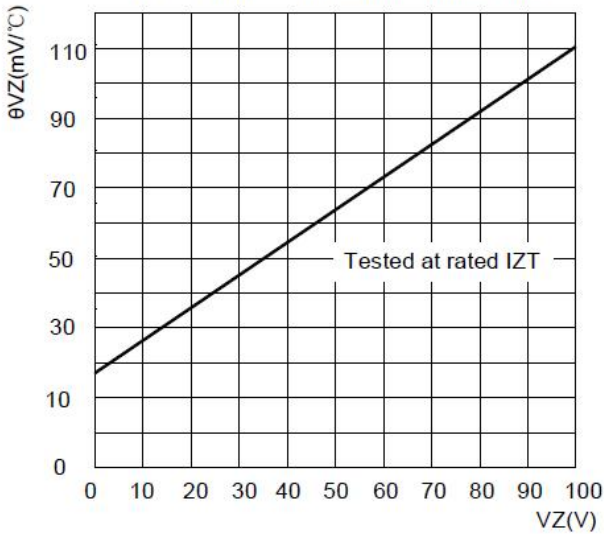

FIG4: Typical Instantaneous Forward Characteristics for SMA4763A

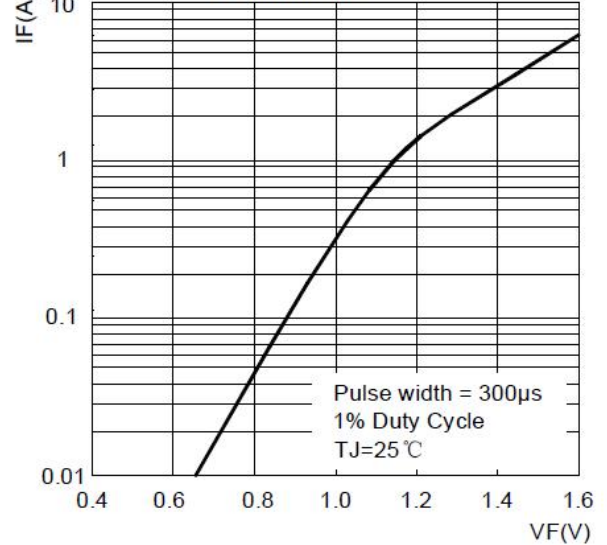
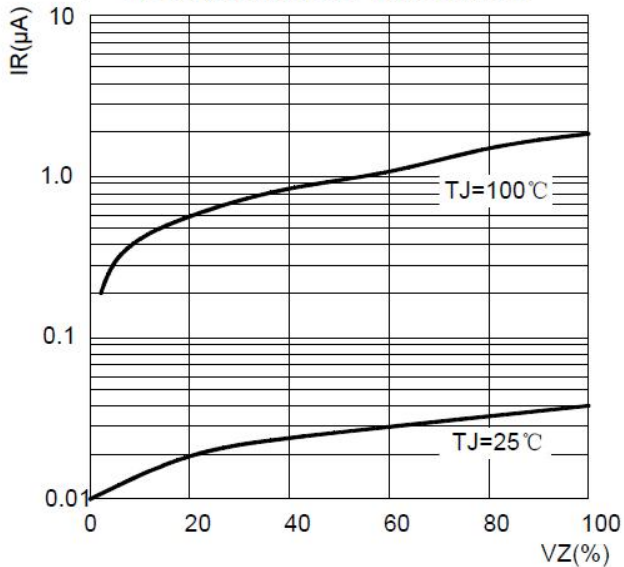
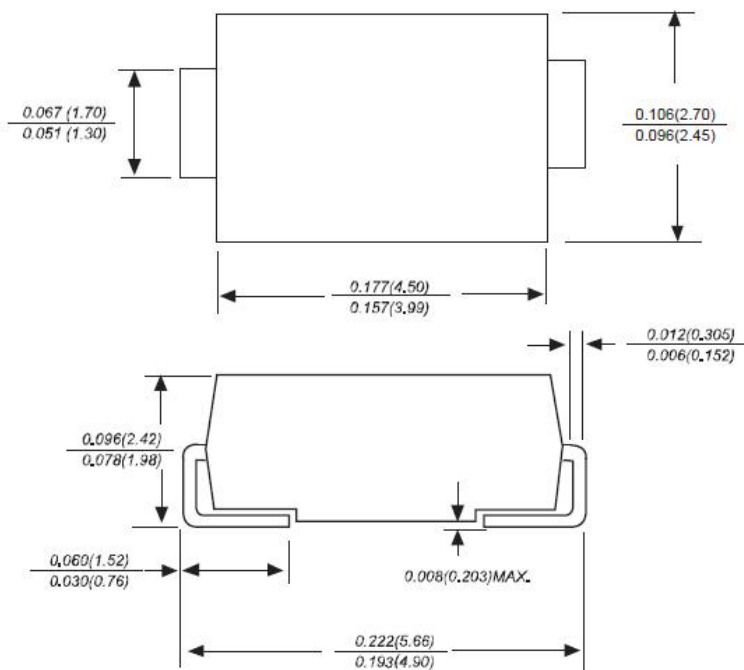

FIG5: Typical Reverse Characteristics



SMAG Package Outline Dimensions



Dimensions in inches and (millimeters)

SMAG Suggested Pad Layout

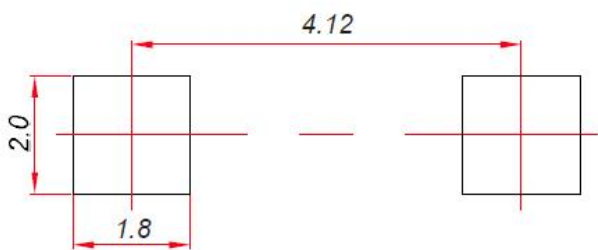

Note:

1. Controlling dimension: In millimeters.
2. General tolerance: ± 0.05 mm.
3. The pad layout is for reference purposes only.

NOTICE

Cloudchild reserve the right to make modifications, enhancements, improvements, corrections or other changes without further notice to any product herein. Cloudchild does not assume any liability arising out of the application or use of any product described herein.

ChongQing Cloudchild Technology Co., Ltd. (short for Cloudchild) exerts the greatest possible effort to ensure high quality and reliability. Nevertheless, semiconductor devices in general can malfunction or fail due to their inherent electrical sensitivity and vulnerability to physical stress. It is the responsibility of the buyer, when utilizing Cloudchild products, to comply with the standards of safety in making a safe design for the entire system, including redundancy, fire-prevention measures, and malfunction prevention, to prevent any accidents, fires, or community damage that may ensue. In developing your designs, please ensure that Cloudchild products are used within specified operating ranges as set forth in the most recent Cloudchild products specifications.

Reel Taping Specifications For Surface Mount Devices- SMAG

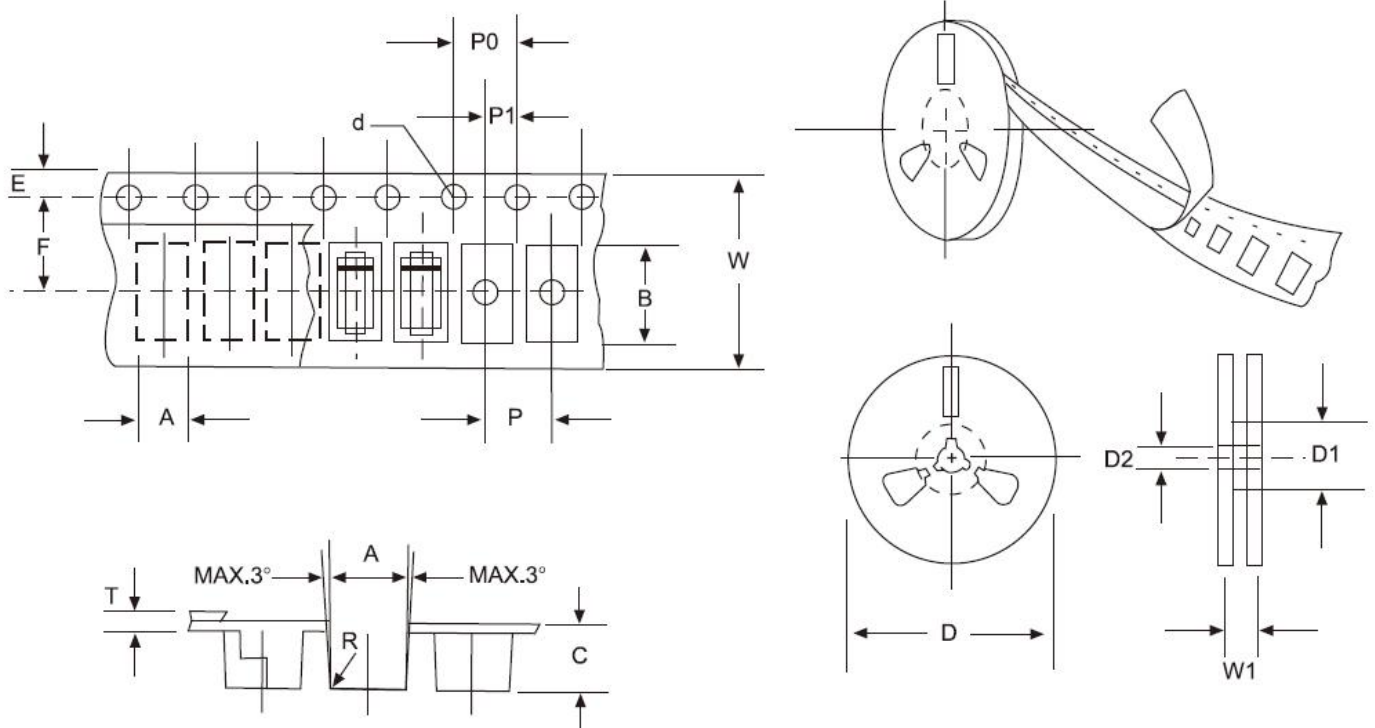

FIG : CONFIGURATION OF SURFACE MOUNTED DEVICES TAPING

| ITEM | SYMBOL | SMAG mm(inch) |
|------------------------|--------|-------------------------|
| Carrier width | A | 2.79±0.1(0.110±0.004) |
| Carrier length | B | 5.33±0.1(0.210±0.004) |
| Carrier depth | C | 2.36±0.1(0.093±0.004) |
| Sprocket hole | d | 1.55±0.05(0.061±0.002) |
| Reel outside diameter | D | 279±2.0 (11± 0.079) |
| Reel inner diameter | D1 | 75 ±1.0 (2.95 ±0.039) |
| Feed hole diameter | D2 | 13±0.5(0.512±0.020) |
| Sprocket hole position | E | 1.75±0.1(0.069±0.004) |
| Punch hole position | F | 5.5±0.05(0.217±0.002) |
| Punch hole pitch | P | 4.0±0.1(0.157±0.004) |
| Sprocket hole pitch | P0 | 4.0±0.1(0.157±0.004) |
| Embossment center | P1 | 2.0±0.1(0.079±0.004) |
| Total tape thickness | T | 0.28±0.02(0.011±0.0008) |
| Tape width | W | 12.0±0.2(0.472±0.008) |
| Reel width | W1 | 16.8±2.0(0.661±0.079) |

NOTE: Devices are packed in accordance with EIA standard RS-481-A and specification given above.

| Date of change | Rev # | revise content |
|----------------|-------|----------------|
| 2023/2/23 | A/0 | / |
| | | |
| | | |
| | | |
| | | |
| | | |